

**AIP SUPPLEMENT
(SUP)****H109/24****Effective: 202408041630 UTC**

AERONAUTICAL INFORMATION SERVICE,
AIRSERVICES AUSTRALIA, GPO BOX 367,
CANBERRA ACT 2601

For **DISTRIBUTION** queries, contact:
Email: aim_editorial@airservicesaustralia.com

For **CONTENT** queries regarding this SUP, contact:
Email: glen.dodds@adgnt.com.au

DARWIN (YPDN) RWY 11/29 RECONSTRUCTION PROJECT: OPERATIONAL RESTRICTIONS DURING WORKS - STAGES 20 AND 21

1. INTRODUCTION

- 1.1 This SUP provides operational information for users of Darwin Airport (YPDN) during Stages 20 and 21 of the RWY 11/29 Reconstruction Project.
- 1.2 These stages include the closure of TWY B1, and temporary displaced thresholds for RWY 11/29 to allow for culvert construction, pavement reinstatement, airfield lighting, drainage and flank regrading, and power supply. Commencement of each stage will be notified by NOTAM.
- 1.3 It is essential that pilots ensure they understand displaced threshold markings and the associated requirements of displaced threshold operations. Pilots are reminded to check YPDN NOTAM during works to ensure they are using the correct RWY distances.

2. REFERENCES

- 2.1 Method of Working Plan - MOWP 23/02 Version 2.5
<https://www.darwinairport.com.au/business/planning-development/method-working-plans>
- 2.2 AIP SUP on <https://www.airservicesaustralia.com/aip/aip.asp>
 - Darwin Aerodrome (YPDN) Ongoing Provision of Aerodrome Flight Information Service (AFIS)
 - Darwin (YPDN) DAP Procedures for Temporary Displaced Threshold RWY 29 – Stage 21

2.3 CASA Approval 07/24

- Equipment to 4.5M high permitted in flyover area 75M to 84M from RWY CL
- Equipment to 8M high permitted in flyover area 84M to 150M from RWY CL

3. STAGE 20

3.1 This stage will be in operation 0200 to 1130 Local (1630 to 0200 UTC), Monday to Saturday.

3.2 Stage 20 is concurrent with Stage 21, commencing 05 August to 02 October 2024.

3.3 Stage 20 works include removal and reconstruction of RWY 11/29 pavement, installation of aeronautical ground lighting, including HIAL demolition and installation, and drainage works.

3.4 RWY 11/29 Details:

- RWY 29 threshold displaced 1,933M
- RWY 11/29 1,873M eastern end closed

	TORA	TODA	ASDA	LDA
RWY 11	1421 (4662)	1481 (4859) (4.0)	1421 (4662)	1421 (4662)
RWY 29	1481 (4859)	1571 (5154) (1.2)	1481 (4859)	1421 (4662)

Supplementary Takeoff Distances

RWY 11	1238 (4061) (1.6)	1294 (4245) (1.9)	1343 (4406) (2.2)	1385 (4541) (2.5)	1448 (4571) (3.3)
---------------	----------------------	----------------------	----------------------	----------------------	----------------------

3.5 Taxiway details:

- TWY A6, TWY B1, TWY D, TWY E1, TWY E2 closed.

3.6 Pavement concession approved for TWY Z and TWY C4 for aircraft operating up to maximum operating weight 42 tonnes.

3.7 TWY C4 not available for engine runs during Stage 20.

4. STAGE 21

- 4.1 This stage will be in operation H24 or 1130 to 0200 Local (0200 to 1630 UTC) when concurrent with Stage 20, commencing 05 August to 02 October 2024.
- 4.2 Stage 21 works include removal and reconstruction of RWY 11/29 pavement, installation of aeronautical ground lighting, including HIAL demolition and installation, and drainage works.
- 4.3 RWY 11/29 Details:
- RWY 29 threshold displaced 1,046M
 - RWY 11/29 874M eastern end closed

	TORA	TODA	ASDA	LDA
RWY 11	2420 (7949)	2480 (8137) (2.0)	2420 (7949)	2420 (7949)
RWY 29	2480 (8137)	2570 (8432) (1.2)	2480 (8137)	2308 (7573)

Supplementary Takeoff Distances

RWY 11	2416 (7926) (1.6)	2469 (8100) (1.9)
---------------	-------------------	-------------------

- 4.4 Caution when backtracking for RWY 29 departure or following arrival RWY 11. Avoid making tight 180 DEG turn.
- 4.5 Taxiway details:
- TWY A6, and TWY B1 closed
- 4.6 When THR RWY 29 displaced: RWY 29 intersection departure from TWY E1 and E2 not available.
- 4.7 RWY 11 intersection departures from TWY B2 available to light single engine aircraft only.

5. PREFERRED TAXI ROUTING

- 5.1 Given the significant impact the RWY works will have on taxiway access, the following preferred taxi routes to/from the Air Transport Apron (ATA) and General Aviation Aprons are designed to reduce conflicts as much as possible. Adherence to these preferred routes is encouraged during AFIS periods and will be applied by Darwin ATC at other times unless deviations are required for operational reasons.

5.2 Stage 20

Departures RWY 11	Taxi to Z, cross RWY 18/36, taxi to C4, backtrack for departure or cross RWY 11/29, taxi to A1 or C as per ATC* instructions; or
	Taxi to B2, backtrack for departure as per ATC* instructions
Arrivals RWY 11	Backtrack (as required) and vacate B2 or V2, taxi to apron as per ATC* instructions
Departures RWY 29	Taxi to B2, backtrack for departure as per ATC* instructions
Arrivals RWY 29	Vacate A1, taxi to C3, cross RWY 11/29 to C4, cross RWY 18/36, taxi to apron as per ATC* instructions
Departures RWY 18	Nil restrictions taxiing to/from RWY 18/36 – taxi for arrivals and departures RWY 18/36 as per ATC* instructions
Arrivals RWY 18	
Departures RWY 36	
Arrivals RWY 36	

**Refer AIP SUP Darwin Aerodrome (YPDN) Ongoing Provision of Aerodrome Flight Information Service (AFIS), Section 3. AFIS Procedures, for departures and arrivals during AFIS between 2200-0600 Local (1230-2030 UTC).*

5.3 Stage 21

Departures RWY 11	Taxi to E2, cross RWY 11/29, taxi to A3, cross RWY 18/36, taxi to C3 or A1 as per ATC* instructions
	Taxi to B2 backtrack for departure as per ATC* instructions
Arrivals RWY 11	Vacate D, taxi to E1 cross RWY 11/29, taxi to apron as per ATC* instructions: or
	Vacate B2, taxi to apron as per ATC* instructions
Departures RWY 29	Taxi to E2 for departure or cross RWY 11/29, taxi to D for departure as per ATC* instructions
Arrivals RWY 29	Vacate A1, taxi to C3, cross RWY 11/29 to C4, cross RWY 18/36, taxi to GA apron as per ATC* instructions
	Vacate A1, taxi to A2, cross RWY 18/36, taxi to E1, cross RWY 11/29, taxi to ATA as per ATC instructions
Departures RWY 18	Nil restrictions taxiing to/from RWY 18/36 – taxi for arrivals and departures RWY 18/36 as per ATC* instructions
Arrivals RWY 18	
Departures RWY 36	
Arrivals RWY 36	

**Refer AIP SUP Darwin Aerodrome (YPDN) Ongoing Provision of Aerodrome Flight Information Service (AFIS), Section 3. AFIS Procedures, for departures and arrivals during AFIS between 2200-0600 Local (1230-2030 UTC).*

6. CONTACT

6.1 For further information contact:

Glen Dodds

Head of Airside Operations

glen.dodds@adgnt.com.au

7. CANCELLATION

7.1 This SUP cancels when Stages 20 and 21 are complete, expected early October 2024.

8. DISTRIBUTION

8.1 Airservices Australia website only.

Appendices

1. Stage 20 Works
2. Stage 21 Works

1. Stage 20 Works

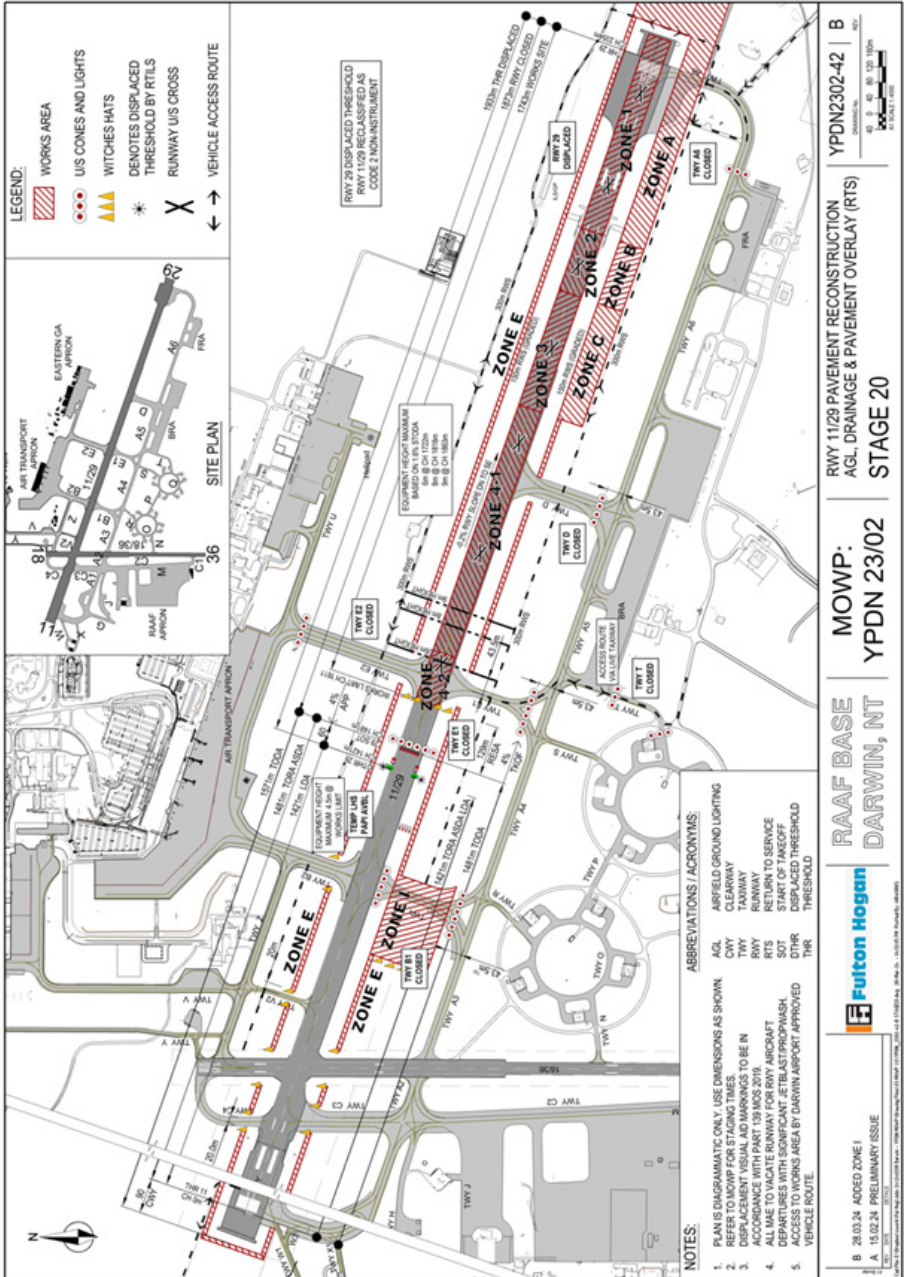

2. Stage 21 Works

